

DEPOSIT OF STATEMENT and PLAN

SECTION 31 (6) OF THE HIGHWAYS ACT 1980

To Sunderland City Council

1. I am and have been since 31<sup>st</sup> October 1998 the owner within the meaning of the above section of the land known as Flinton Hill Farm, Penshaw more particularly delineated on the plan accompanying this statement and thereon edged red.
2. The aforementioned land lies in the Parish of City of Sunderland.
- ~~\* 3. The ways coloured blue on the said plan have been dedicated as highways with vehicular status.~~
- \* 4. The ways coloured green on the said plan have been dedicated as bridleways.
- \* 5. The ways coloured yellow on the said plan have been dedicated as footpaths.
- \* 6. No ways over the land have been dedicated as highways.
7. The deposit shall comprise this statement and accompanying plan.

\* Delete as applicable.

LANDOWNERS :

Signed: 

Name: A COXON ESQ

Address: Offerton Grange, Offerton, Sunderland, SR4 9JL

Date: 6<sup>th</sup> July 2000

WITNESS :

Signed: 

Name: S COXON

Address: Offerton Grange Farm Offerton Village Sunderland.

Occupation: Housewife

# FLINTON HILL FARM

## Sunderland, Tyne and Wear

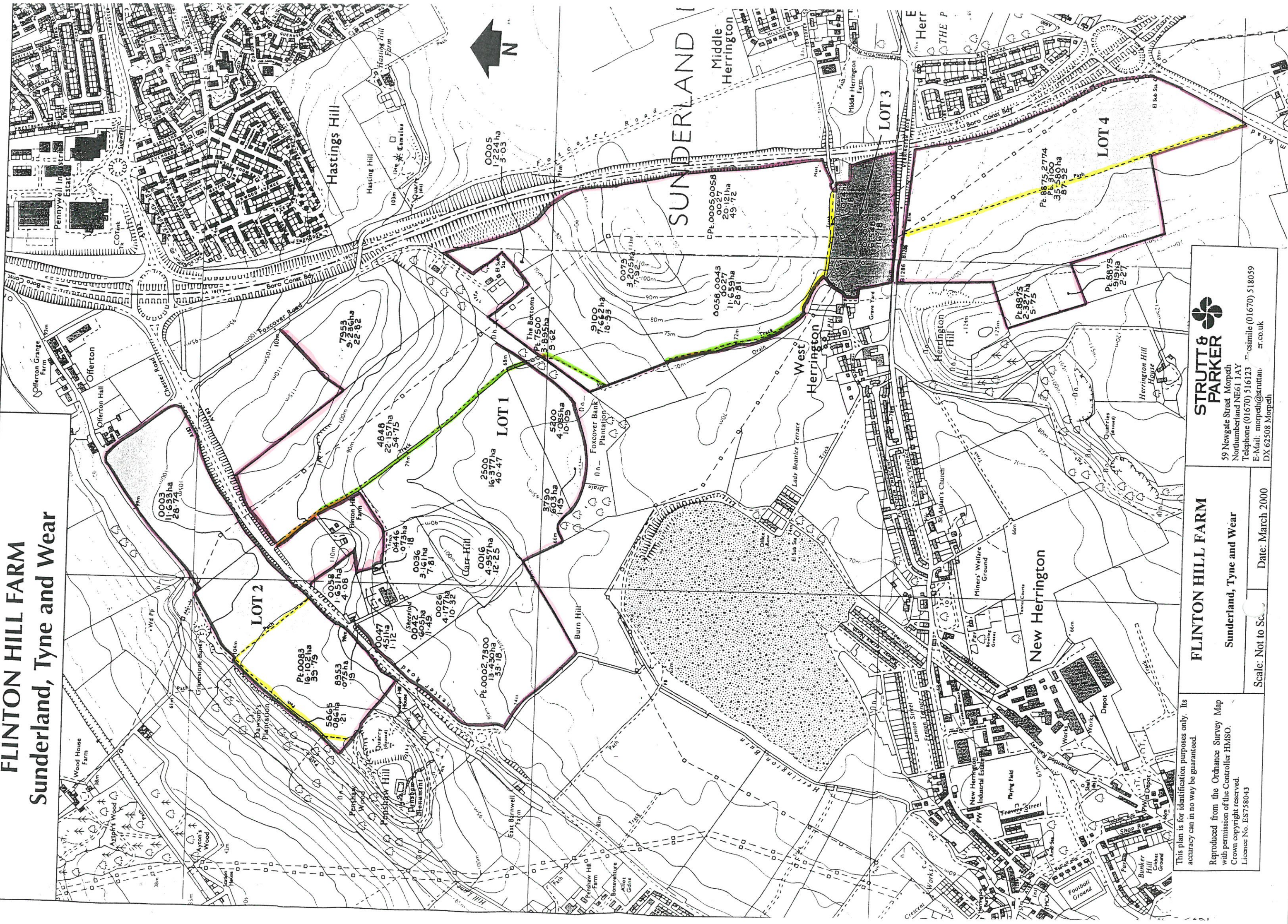

This plan is for identification purposes only. Its accuracy can in no way be guaranteed.

Reproduced from the Ordnance Survey Map with permission of the Controller HMSO. Crown copyright reserved. Licence No. ES758043

### FLINTON HILL FARM

Sunderland, Tyne and Wear

Scale: Not to Scale

Date: March 2000



**STRUTT & PARKER**  
 59 Newgate Street, Morpeth  
 Northumberland NE61 1AY  
 Telephone (01670) 516123  
 E-Mail: [morpeth@struttan.co.uk](mailto:morpeth@struttan.co.uk)  
 Facsimile (01670) 518059  
 DX: 62508 Morpeth